

UK Strategy on Accelerator R&D

- **Major government commitments:**
 - **DIAMOND funded: 350 Meuro + 150 Meuro**
 - **Creation of ASTeC (2001) by CCLRC**
 - **Creation of Cockcroft and Adams Institutes (2004) by PPARC**
 - **Accelerator science boost (2004-2007) : ~ 25 Meuro**
- **PPARC/CCLRC priorities:**
 - **Linear Collider BDS (see EUROTeV + LC-ABD) ~ 15 Meuro**
 - **Major role sought: GDO bid**
 - **Technology transfer to industry (via collaborations)**
 - **Synergies: eg high brightness sources, SRF systems, diagnostics**

NB ERLP project funded at Daresbury (~ 20 Meuro)

ERLP at Daresbury

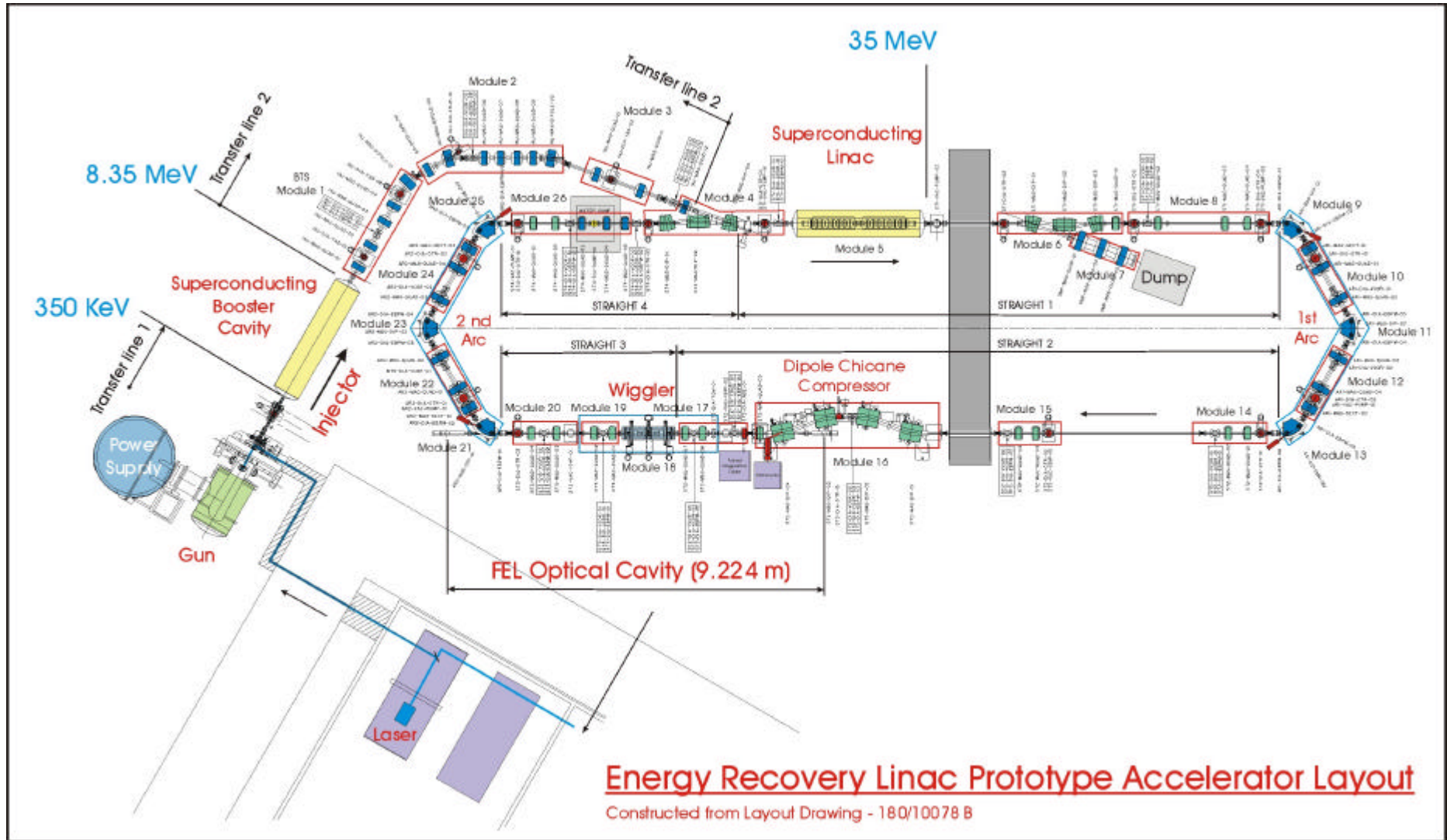

ERLP Layout

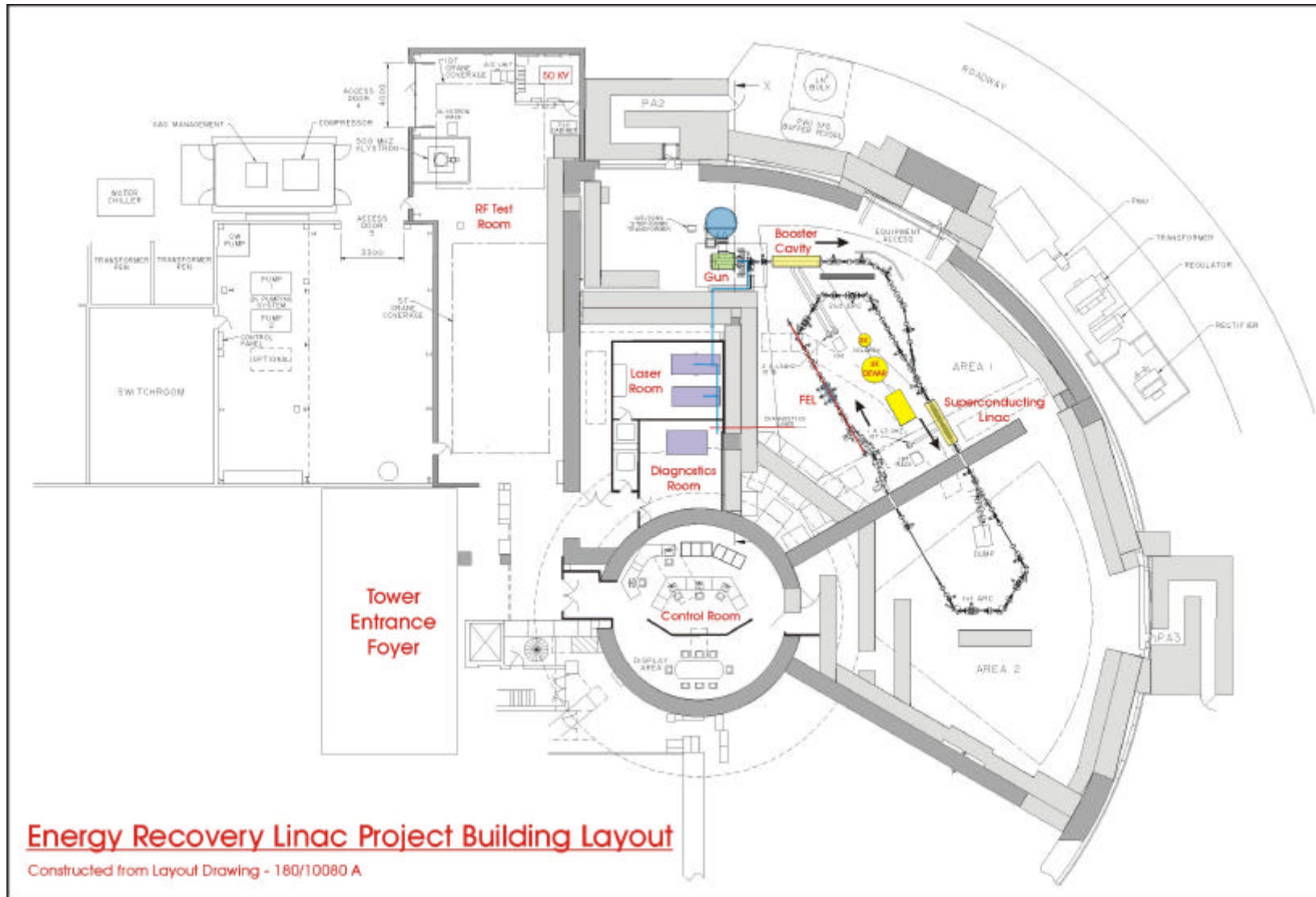

Additional Potential Initiatives (1)

Comment:

CARE/EUROTTeV concentration on ‘critical’ R&D items - but full TDR needed by 2007 !

Generic (Core) Topics

- **All beam dynamics**
- **RF systems (structures + sources)**
- **Vacuum science**
- **Diagnostics**
- **Accelerator engineering**
- **Project management**
- **Technology transfer**

Additional Potential Initiatives (2)

Specific LC Topics

- **RF systems (LC-ARF)**
 - **Consortium formed: design/build/test**
 - **Technology task forces being created**
 - **Industrial collaborations initiated**
 - **Desire for international engagement**
- **Laser driven guns**
- **Beam dump**
- **Radiation protection**
- **Accelerator test facility**

LC-ARF Process Plan

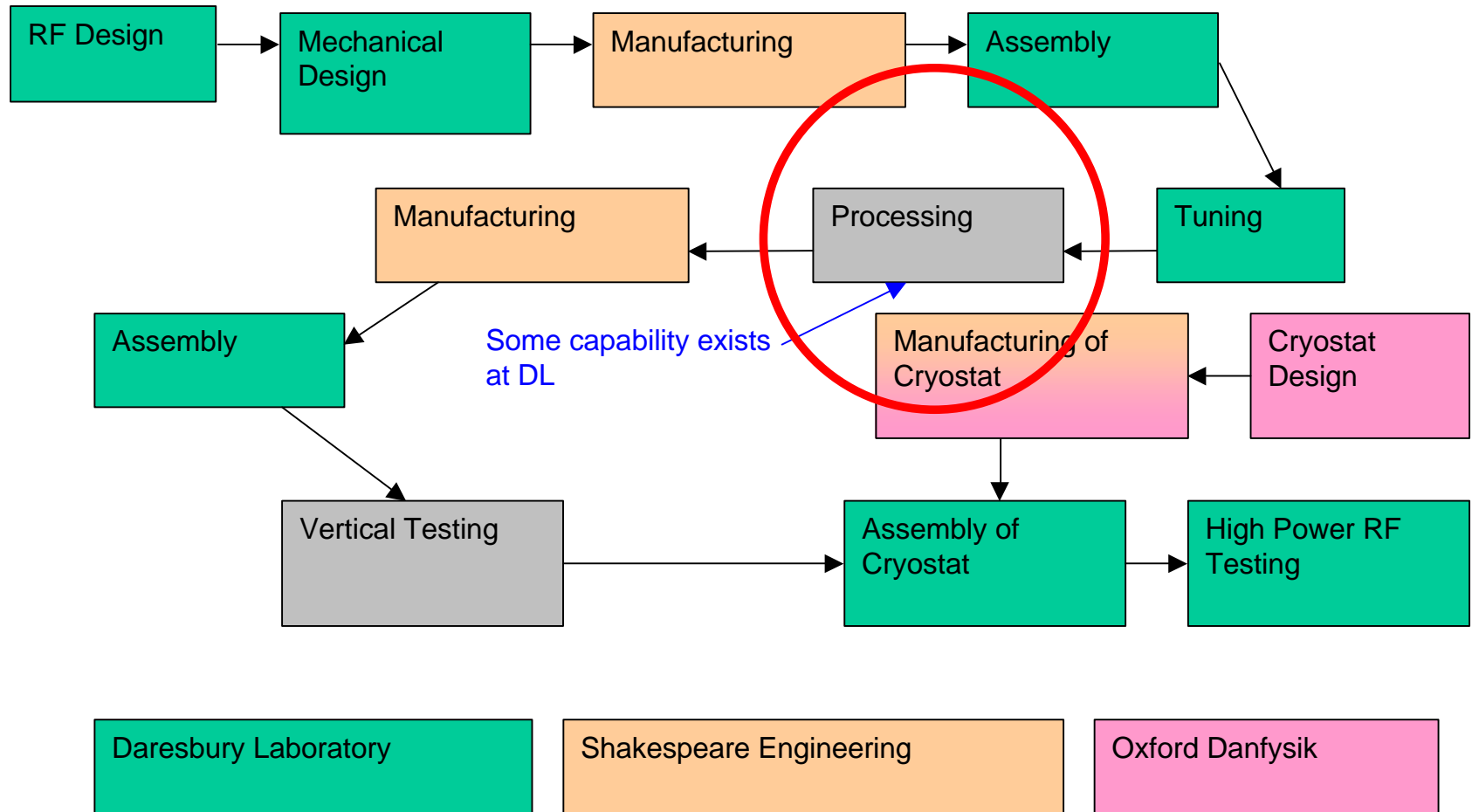

Proposed SRF Location

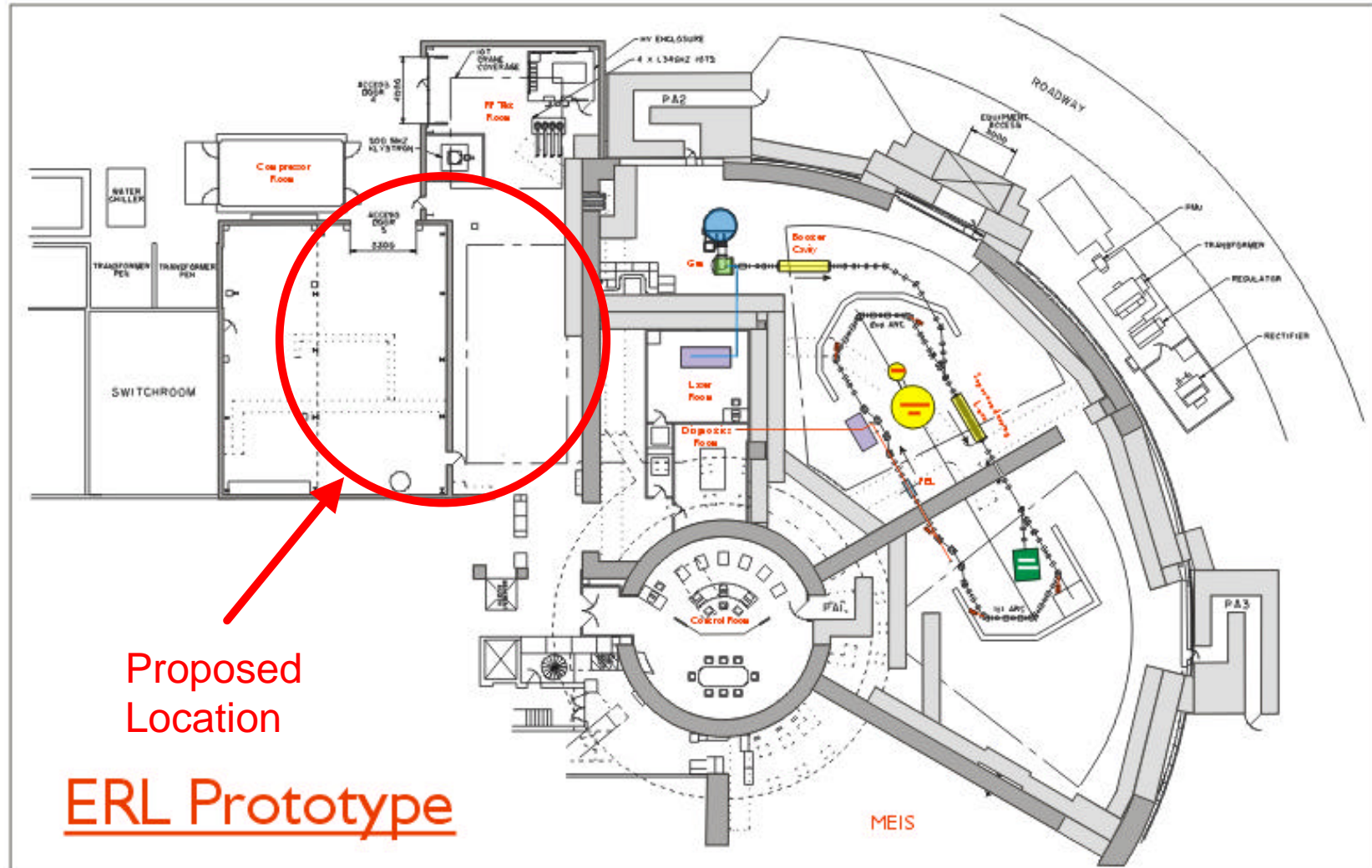

Location Details

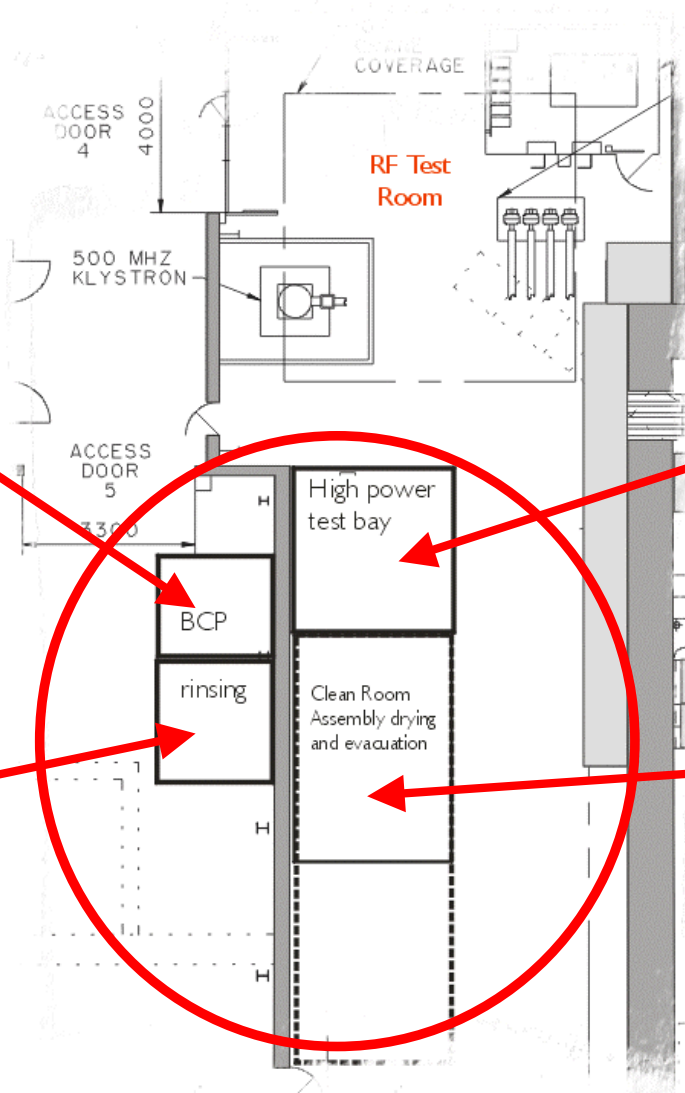

Additional Potential Initiatives (2)

Specific LC Topics

- **RF systems (LC-ARF)**
 - **Consortium formed: design/build/test**
 - **Technology task forces being created**
 - **Industrial collaborations initiated**
 - **Desire for international engagement**
- **Laser driven guns**
- **Beam dump**
- **Radiation protection**
- **Accelerator test facility**